

PERMANENT MAGNETIC ASSEMBLIES

Maximum holding power is obtained when the unit is in direct contact with a surface slightly larger than the magnet face. For each size of magnet there is a minimum load thickness to achieve maximum holding power. Alnico magnet assemblies can handle temperatures up to 800 degrees Fahrenheit. Ceramic magnet assemblies can handle temperatures up to 200 degrees Fahrenheit.

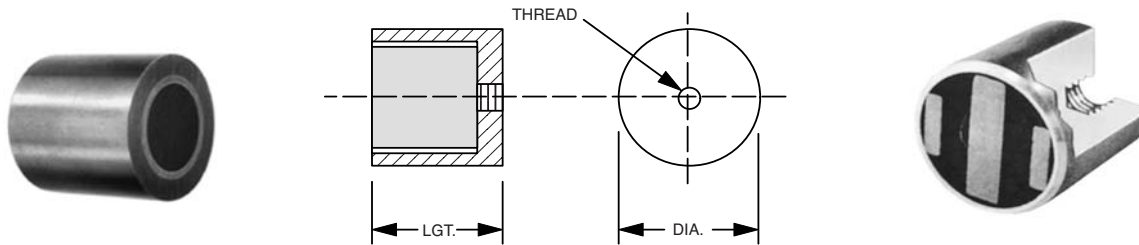

TAPPED ALNICO ASSEMBLIES

PRODUCT NUMBER	DIA.	LENGTH	TAP	POWER (LBS)
1290-T-08	0.250	0.500	8-32	0.34
1291-T-08	0.312	0.500	8-32	0.79
1292-T-08	0.375	0.500	8-32	1.55
1293-T-08	0.500	0.500	10-32	2.50
1293-T-12	0.500	0.750	10-32	3.00
1293-T-16	0.500	1.000	10-32	3.50
1294-T-08	0.625	0.500	10-32	2.75
1294-T-12	0.625	0.750	10-32	4.25
1294-T-16	0.625	1.000	10-32	4.80
1295-T-08	0.750	0.500	10-32	5.25
1295-T-12	0.750	0.750	10-32	9.15
1295-T-16	0.750	1.000	10-32	9.45
1295-T-20	0.750	1.250	10-32	10.00
1296-T-08	0.875	0.500	1/4-20	8.60
1296-T-12	0.875	0.750	1/4-20	13.20
1296-T-16	0.875	1.000	1/4-20	16.50
1296-T-20	0.875	1.250	1/4-20	17.30
1297-T-08	1.000	0.500	1/4-20	7.25
1297-T-12	1.000	0.750	1/4-20	15.50
1297-T-16	1.000	1.000	1/4-20	17.00
1297-T-20	1.000	1.250	1/4-20	19.00
1298-T-12	1.250	0.750	1/4-20	17.50
1298-T-16	1.250	1.000	1/4-20	21.00
1298-T-20	1.250	1.250	1/4-20	25.00
1298-T-24	1.250	1.500	1/4-20	27.00

CERAMIC ASSEMBLIES

PRODUCT NUMBER	DIA.	LENGTH	TAP	POWER (LBS)
2-POLE ASSEMBLIES				
1100-08	0.250	0.500	--	0.100
1100-12	0.250	0.750	--	0.150
1102-08	0.375	0.500	--	1.000
1102-12	0.375	0.750	--	1.750
1102-16	0.375	1.000	--	2.250
1104-08	0.500	0.500	--	2.750
1104-12	0.500	0.750	--	3.250
1104-16	0.500	1.000	--	3.750
3-POLE TAPPED ASSEMBLIES				
2200-T-08	0.625	0.500	10-24	2.300
2200-T-12	0.625	0.750	10-24	5.100
2200-T-16	0.625	1.000	10-24	7.100
2201-T-08	0.750	0.500	10-24	5.000
2201-T-12	0.750	0.750	10-24	7.800
2201-T-16	0.750	1.000	10-24	9.800
2202-T-08	0.875	0.500	1/4-20	6.200
2202-T-12	0.875	0.750	1/4-20	11.800
2202-T-16	0.875	1.000	1/4-20	16.600
2203-T-08	1.000	0.500	1/4-20	8.400
2203-T-12	1.000	0.750	1/4-20	17.600
2203-T-16	1.000	1.000	1/4-20	20.800
2204-T-08	1.250	0.500	1/4-20	7.200
2204-T-12	1.250	0.750	1/4-20	22.800
2204-T-16	1.250	1.000	1/4-20	26.000
2204-T-20	1.250	1.250	1/4-20	34.000

PAINTED ALNICO MODELS

E-831	0.687	0.625	10-32	6.000
E-832	0.812	0.750	10-32	9.000
E-833	1.062	1.000	10-32	15.000
E-834	1.375	1.875	10-32	44.000